

Stay CONNECTED on
Social Media

www.jaincollege.ac.in/socialmedia



Become a fan of our
facebook page to
get regular updates!



Follow us on twitter to
hear our latest tweets!



Watch and share
videos of events and
other activities on YouTube



Watch and share videos
and images of events and
other activities on Flickr

Jain College
JGI Knowledge Campus, #44/4, District Fund Road, Jayanagar 9th Block
Near Bangalore Central, Behind Big Bazaar, Bangalore - 560 069
P +91 80 4343 0904 M +91 98860 85608
E arg@jgi.ac.in W www.jaincollege.ac.in



JAIN COLLEGE

www.jaincollege.ac.in



11 - 599
Concept & Design, Office of HR, Communications & Corporate affairs, The JGI Group

18 month full time PGDBM Programme from EDII, Ahmedabad

PLUS

6 month IIAM / IIAB training

AND

MBA through Twinning Programme from a UGC recognized Central University



Welcome!

Contents

Welcome	01
About Us	04
About EDII	06
Get Ready to be Inspired	10
Striking the Right Balance	12
Jain College - CME	14
Programme Architecture	16
Fostering Entrepreneurial Thinking	18
Developing Your Employability	22
Active Life	24
Settling In	26
Enchanting City of Bangalore	28
Facilitating Academic Excellence	30
Media Speak	32
Corporate Speak	34
JGI Corporate Relations	36
The JGI Group	38
Campus Location	40
Admission Criteria	41



If you are reading this prospectus, you have probably made the decision to enhance both your professional knowledge and your future job prospects.

Original Thinking Applied. These three words are fundamental to what The JGI Group is all about and are at the heart of everything we do. Jain College is the home of original thinkers and our long and proud history of educational excellence continues the spirit of innovation and achievement. But world-class education alone is not enough. We believe that original thinking is only meaningful if it is applied - it should have an impact on the shopping malls, in boardrooms and across every business and make a difference to people's lives. Our management programmes combine the best in academic theory with practical, real life projects so that our students not only get an outstanding learning experience, but can apply their knowledge to solving the business problems of the future.

Dr. R Chenraj Jain
Chairman, The JGI Group

Message from the Director, EDI



Entrepreneurship is the answer to achieving growth. I am happy that it has come to be perceived as an attractive career, especially by the youth.

Entrepreneurship Development Institute of India (EDI), Ahmedabad is dedicated towards creating a breed of business-savvy, well aware, confident, motivated and inspiring young entrepreneurs. The Institute's entrepreneurship programmes do not merely impart know-how on creating a new business enterprise but, being market driven such programmes also ensure sustainable growth of the enterprise. The programmes have always taken into account the possibility of obsolescence of strategies and methodologies amidst the changing times, and guide the students appropriately.

The youth get equipped with winning traits, knowledge and right attitude. The youth also develops a distinct opportunity sensing ability with the propensity to take calculated risks. Collaborating with SBMJC offers another opportunity for EDI to interact with the pillars of the Nation...the youth and society at large. I hope more and more young people come onto the scene to embrace entrepreneurship.

Here's wishing you all a great career in entrepreneurship!

Dr. Dinesh Awasthi
Director, Entrepreneurship Development Institute of India, Ahmedabad

Message from the Chairperson, EDI



Indian entrepreneurship environment is replete with inspiring success stories. We have instances of first generation entrepreneurs who have made it big after having undergone training and counselling in entrepreneurship. Entrepreneurship can be a rewarding career option for the youth of today. Several youth have also made a conscious choice in favour of entrepreneurship but for the phenomenon to be widespread, society needs to be sensitised about its advantages...the awareness needs to get deeper into the folds of the society to create a noticeable impact. Realising this, EDI focuses on entrepreneurship development by designing and offering innovative programmes to orient students to opt for entrepreneurship as a career.

Today entrepreneurs need to possess knowledge and dynamism to excel. They need to adhere to benchmarks, like; better products, lower cost, good quality, competitive prices, technology and reduced response time, besides possessing details about policy structures, if they wish to excel and, this makes training in the area mandatory.

I urge all potential, emerging and existing entrepreneurs to rely on sound knowledge and a well guided growth plan to succeed.

I wish best of luck to all!

Dr. Sunil Shukla
Chairperson, PG Studies & Chief Faculty, EDI Ahmedabad

To keep pace with the future and prepare students to face the challenges and demands of the business world, SBMJC offers a unique twinning programme - A full time 18 month Post Graduate Diploma in Business Management (PGDBM) PLUS 6 month IIAM / IIAB training programme with dual specialization in Marketing and Finance or HR offered by the Entrepreneurship Development Institute of India (EDII), Ahmedabad.

The students are encouraged to pursue a Two Year MBA from a UGC recognized University.

“ The campus at EDII, Ahmedabad reminds one of the gurukul days, so peaceful, serene and with a blend of best facilitators. ”

Richa Agarwal , PGDBM - 09



Students at EDII - Ahmedabad

About Us



Jain College

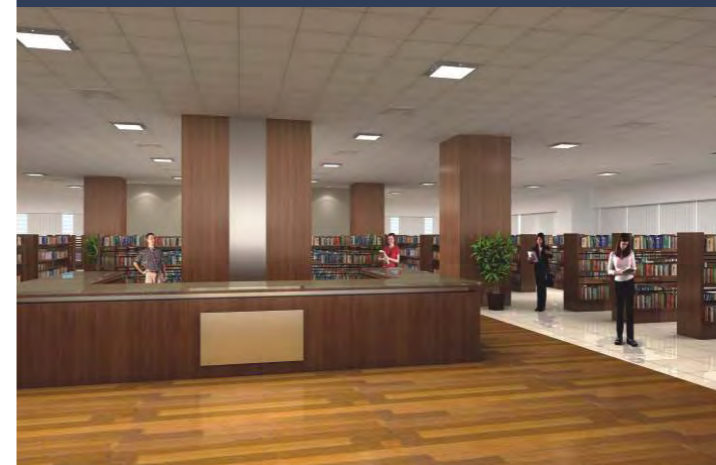

Sri Bhagawan Mahaveer Jain College (SBMJC) is the flagship institute of The JGI Group, headquartered at Bangalore. The group represents a cluster of 59 educational establishments, that are home to over 30000 students from across the world & over 3120 staff members engaged at the P-12, undergraduate & postgraduate levels across 20 campuses and centres of excellence.

SBMJC pioneered into commerce and management education in the year 1990. It brings in thought leadership with a blend of academic rigour with hands-on applicability to real-world issues. The learning environment is enriched by a combination of highly talented & motivated staff.

Twinning Programme



The twinning programme is from an university which is recognised by the University Grants Commission (UGC). The University is a member of the Association of Indian Universities and the Association of Commonwealth Universities.

Twinning Programme is a concept where the Memorandum of Understanding is signed between reputed institutions to facilitate effective programme delivery to the students. The marked difference between the conventional Distance Education programmes and this innovative twinning programme is that the students would undergo rigorous classroom sessions.

All qualifications awarded by Universities established by an Act of Parliament are recognized for the purpose of employment to posts and services under the Central Government provided it has been approved by Distance Education Council (DEC). The University is approved by DEC.

EDII, Ahmedabad is proudly associated with NITEDB, GOI in developing Science & Technology Entrepreneurs.



About EDII



The Entrepreneurship Development Institute of India (EDII), an autonomous body and a not-for-profit institution was set up in 1983. It is a globally recognized premier institute in entrepreneurship and management education. EDII has taken approval from AICTE for its residential PG programme. It is sponsored by apex financial institutions, namely the Industrial Development Bank of India (IDBI), the Industrial Finance Corporation of India (IFCI), the Industrial Credit and Investment Corporation of India (ICICI) and State Bank of India (SBI) and also supported by the Government of Gujarat. The institute is registered under the Societies Registration Act 1860 and the Public Trust Act 1950.

The EDI is also a member of the Economic and Social Commission for Asia and the Pacific (ESCAP) network of Centres of Excellence for HRD Research and Training. As a part of the bilateral Institutional Cooperation between University of Kelaniya, Sri Lanka and Entrepreneurship Development Institute of India, an Entrepreneurship Development Centre in Sri Lanka for entrepreneurship education, training, research and business incubation is also to be established.

EDII has been spearheading entrepreneurship movement throughout the nation with a belief that entrepreneurs need not necessarily be born, but can be developed through well-conceived and well-directed activities.

EDI International Sponsors

- World Bank
- UNIDO
- UNDP
- ILO
- GTZ
- Friedrich- Naumann -Stiftung (FNSt)
- British Council
- African Development Bank
- Asian Development Bank
- Commonwealth Secretariat
- Ford Foundation
- USAID

List of EDI Sponsors (National)

- SIDBI
- NABARD
- Department of Science and Technology (Govt. of India)
- Bharti Foundation
- KVIC
- DIC
- Kudumbashree
- Ministry of Urban Employment & Poverty Alleviation (Govt. of India)
- Ministry of Panchayati Raj (Govt. of India)
- Ministry of Rural Development (Govt. of India)
- ITEC, Ministry of External Affairs (Govt. of India)
- Ministry of Food Processing (Govt. of India)
- Industries Commissioner (Govt. of Gujarat)
- Ministry of Textiles, Office of DC (Handlooms), (Govt. of India)
- Ministry of Textiles, Govt. of Kerala
- Coir Board, Kerala
- Accenture
- Hewlett Packard
- Rashtriya Gramin Vikas Nidhi (RGVN)
- Central Silk Board
- TISCO

Facilitators from EDII, Ahmedabad

- ✦ Dr. Dinesh Awasthi, Ph.D. (Economics) Director
- ✦ Dr. Sunil Shukla, Ph. D. (Psychology) Chairperson - PGPs
- ✦ Dr. B. B. Siddiqui, Ph.D. (Psychology)
- ✦ Dr. Binod Das, Ph.D. (Political Sociology)
- ✦ Dr. Pankaj Bharti, Ph.D. (Psychology)
- ✦ Dr. Sasi Misra, Ph.D. (Psychology)
- ✦ Dr. Subhransu Tripathy, M. A.(Sociology), Ph.D.(Eco.)
- ✦ Dr. Thimmappa K, Ph.D. (Agriculture Economics)
- ✦ Prof. A. B. Raju, B.Tech (Mech), PGDRM
- ✦ Prof. Ajay Dixit, B.A.
- ✦ Prof. Bipin Shah, B.Sc.(Chem.), MBA (Finance)
- ✦ Prof. C. R. Patnaik, PGDM
- ✦ Prof. D. D. Trivedi, M.Com.
- ✦ Prof. D. M. Parikh, B.E. (Mechanical), M.Tech. (Ind. Mgt.)
- ✦ Prof. Ganapathi Batthini, M.L.I.Sc., Net Qualified
- ✦ Prof. Hemang Desai, B.Sc., MSW, Dip. TD, PGDIP. Psy. Counseling
- ✦ Prof. J. B. Patel, B.Sc. (Chem.), B.Sc. (Tech.)
- ✦ Prof. Jignasu Yagnik, M.Sc., DCO, MBA
- ✦ Prof. K. K. Shaw, B.E. (Hon.) Mechanical ,PGBEM
- ✦ Prof. K. Nagaraja Rao, M.A. (Political Science) AIII
- ✦ Prof. Kumar Mukul, M. A.
- ✦ Prof. Manoj Mishra, M.Sc., PGDFM
- ✦ Prof. Mayank Upadhyay, ACWA
- ✦ Prof. Meena Bilgi, M. Phil. (Social Work)
- ✦ Prof. N. Ramesh, M. Sc. (Chemistry)
- ✦ Prof. P. N. Srivastava, M.Com.
- ✦ Prof. Prakash Solanki, B.Sc. (Chem.), PGDPPT, PGDBM, PGDRD,LL.M., M.A. (Sociology)
- ✦ Prof. Pramod Srivastava, M.A. (Economics)
- ✦ Prof. Rajesh Gupta, M.Com; PGDBM
- ✦ Prof. Raman Gujral, M.Com.
- ✦ Prof. S. B. Sareen, Dip. in Textile Technology, D.I.M, D.I.M.O.(Hon.), D.M.M.
- ✦ Prof. Sanjay Pal, M.Sc. (Economics), MBA (Marketing)
- ✦ Prof. Satya Ranjan Acharya, M.Sc. (Ag), MFC, PGDBA
- ✦ Prof. Tarun Bedi, B.E. (Civil), M.A. (Sociology)
- ✦ Prof. Umesh Menon, M.Com, MBA (Finance), Grad. C.W.A.
- ✦ Prof. V. Padmanand, M. Phil CRENIEO, M. Phil., PGDMM
- ✦ Prof. V. S. Sukumaran, LL. B, PGDHRD, PGDTD, PGDM, MBA
- ✦ Prof. Vivek Shah, B.Com (Hons) PGDBM, PGDIRPM, LLB

Glimpses of the Convocation at EDII, Ahmedabad



Dr. Vijay Mallya
Chairman, UB Group & Kingfisher Airlines



Mr. Venugopal N Dhoot
Chairman and MD, Videocon Industries Ltd.



Dr. Kumar Mangalam Birla
Chairman, Aditya Birla Group



Mr. Anil D Ambani
Chairman, Reliance Anil Dhirubhai
Ambani Group

EDII Governing Council

Shri R.M. Malla
President - EDI
Chairman and MD, IDBI Bank Ltd., Mumbai

Dr. Yoginder K. Alagh
Vice Chairman & Professor Emeritus
Sardar Patel Institute of Economic & Social
Research, Ahmedabad

Shri D.P. Bagchi, IAS (Retd.)
Ex-Chief Secretary, Orissa

Mrs. K. Rama Devi
President
Association of Lady Entrepreneurs of Andhra
Pradesh, Hyderabad

Shri Anand T. Kusre
Nominee Member of ICICI Bank Ltd., Mumbai

Shri M.K. Nag
Chief General Manager (SME)
State Bank of India, Mumbai

Dr. Sailendra Narain
Chairman, Centre for SME Growth &
Development Finance Navi Mumbai

Shri Atul Kumar Rai
Chief Executive Officer & MD, IFCI Limited
New Delhi

Shri V.S. Rathore
Executive Director
Small Industries Development Bank of India
SME Development Centre, Mumbai

Shri B. Ravindranath
Executive Director
IDBI Bank Ltd., Mumbai

Shri Maheshwar Sahu, IAS
Principal Secretary
Industries & Mines Department, Govt. of
Gujarat, Gandhinagar

Shri Umesh Chandra Sarangi, IAS
Chairman
National Bank for Agriculture & Rural
Development, Mumbai

Shri Uday Kumar Varma, IAS
Secretary (MSME)
Ministry of Micro, Small & Medium Enterprises,
Government of India
New Delhi

Dr. Dinesh Awasthi
Director
Entrepreneurship Development Institute of
India, Ahmedabad

Welcome to the start of a very exciting journey. When you become a student of SBMJC you will meet people from all walks of life, make lifelong friends and find yourself being inspired, challenged & stimulated. Spending time at SBMJC is an investment in your future and we want to make sure you leave with a quality qualification.



Get Ready to be Inspired

More Personalized Approach

Whatever your motivations for pursuing a PGDBM programme, you'll find the SBMJC PGDBM a transformational experience opening doors to new opportunities and challenges. As soon as you arrive in SBMJC, we start working with you to support you in your journey to career advancement. Through individual advice sessions with our careers team, professional workshops with consultants and recruiters, on-campus visits from blue-chip recruiters, as well as using our alumni network, we will help you set realistic career goals and give you every opportunity to achieve them.



Jain College PGDBM students won the first prize at Symbiosis International University's National Level Fest – "Colossus" Business Bazaar event and were awarded with a cash prize of Rs. 20,000/-

Invigorating Resources

Guidance, support and inspiration are on hand at all times to facilitate and give the impetus necessary to break frontiers and stride ahead. We provide students with unparalleled resources. Students have access to a pleasing learning ambience and a superior infrastructure.

Some of the student amenities include:

- Laptops & Wi-Fi enabled campus
- LCD facility for business news analysis
- Well equipped library with National & International journals
- Amphitheatre classroom
- Spacious seminar halls for guest lecture and professional workshop series
- TFT monitor computers in labs with internet facility
- Hygienic cafeteria
- Separate hostel facilities for boys and girls



A Classroom Session in Progress

Top Class Teaching

The best academic minds are devoted to business research and teaching. The faculty is distinguished by its dedication, enthusiasm and commitment. It is comprised of talented people many with advanced degrees, who possess a deep knowledge of the subjects they teach and have a unique understanding of students and how they learn best.

We believe and rightly so, that education is one that can and must be applied in real life situations. The seminars, fests, workshops, internships, speaker series, competitions, meets and forums complement classroom learning. Communication and leadership development skills are imparted by Toastmasters International - CC Qualification (USA).

“ The teaching by industry achievers makes learning fun & understandable. ”
Prerna Gupta, PGDBM - 10



Students during an industrial visit to China

Striking the Right Balance

The Business English Certificate *



Business English Certificate - BEC is a globally recognized international examination designed by the University of Cambridge ESOL Examinations to assess Business English proficiency. BEC is an internationally recognized qualification in English for work. It is recognized by 140 companies and many universities in more than 60 countries. Preparing for BEC improves your confidence in using business English, particularly in speaking.

Microsoft Office Specialist *



A Microsoft Office Specialist (MOS) certification helps validate proficiency in using Microsoft Office 2007 and meets the demand for the most up-to-date skills on the latest Microsoft technologies. Candidates who pass a certification exam show that they can meet globally recognized performance standards.

Campus Recruitment Leadership Training Programme *

This programme is designed to aid candidates in their preparation for recruitment through Campuses or outside campuses. Students in their final year looking for placement in reputed organizations can make use of this programme to get trained to deliver their best in the selection processes of various corporates tied up with our Institutions.

*TC apply

Jainicia - National Level Management Fest

Jainicia is a National Level Management Fest organized by Jain College every year, at the MBA & PGDBM level. It is spread over 2 days, drawing in the best talents from across the country. The first year itself saw a participation of over 30 colleges. The fest has events in the areas of Marketing, Finance, Human Resource, Business Quiz, Operations, Best Manager and Entrepreneurship, and has become the most awaited fest PAN India. Jainicia provides a platform for the students to showcase their talent and competencies at a professional level.



Professional and Social Clubs

A good management student needs to have knowledge about latest events having an impact on business conditions. These clubs see the participation by professionals of repute from industry who shares their knowledge and perceptions of current trends. The interactions help students develop an appreciation for the practical application of their knowledge and also to develop a managerial perspective on operation and decision making. Some of our clubs include Finance Club, Marketing Club, HR Club, Sports Club, Healthcare Club, Quiz Club, Entrepreneurship Club, Green Club, CSR Initiative and Cultural Club.

Global Achiever Workshop Series

Global achievers from London Business School, UK, Stanford, USA or Industry experts from any segment / sector of business share their experiences and inspire our students in this workshop series.

Outbound Learning Programme

Outbound Learning Programme is a personality development programme with brain teasing games, physical exercises, meditation, trekking, etc to focus on team building, leadership and group dynamic skills.

“ The SBMJC- EDI, PGDBM programme has proved to be a milestone in my professional and personal life. I am able to correlate my learning from SBMJC-EDI to my family business, with better planning and internal management. ”



Neelabh Goswami
Placed in Oracle

Global Exposure + MDP

In today's business world every student should know and understand the best practices of the West. Visits to foreign countries give students the platform to understand the best of both the world. Initial grooming and training on Global Culture and Etiquettes is provided to students on the Global Excellence Trail. Industrial visits are also mandatory to understand the latest trends in various sectors of business and management.

International Toastmasters - Speech Craft



Communication is an important component of any Management / Business activity. International Speech craft is one such initiative to develop the communication skills of the Management Graduate. It also helps in developing the self confidence of the student. Successful students undergoing this rigorous module get a certificate given by International Toastmasters, USA.

Students on Global Excellence Trail



SBMJ-CME (Sri Bhagawan Mahaveer Jain - Centre for Management and Entrepreneurship) is built by intellect and driven by innovations since 1990. It starts with a selection matrix by measuring student's present market readiness, designing an individual development, mentoring growth path, Injecting special treatment modules to take the candidate to a higher platform.

“ The PGDBM programme has exposed me to the practical aspect of being associated with the largest telecommunication provider in the North-East - Aircel Ltd. ”

Bedashree Gogoi, Intern - Aircel Ltd.



Jain College (SBMJ CME)

SBMJ-CME @ first semester

First semester at SBJM-CME is supposed to be the most challenging time for a fresh graduate. Corporate journey begins by understanding consumer. Students start appreciating different facets of business management and try to understand how marketing strategy is different from sales tricks, how mutual fund is different from small savings scheme or how do one hire 10,000 best graduates from engineering colleges spread around the country and keep them happy with their personal growth expectations year after year.

Pre-requisite Programmes

SBMJ-CME prepares selected candidates for the high pressure course long before it starts the actual programme. During pre induction sessions, SBJM-CME tries to encourage reading habit, inject industry awareness through well planned modules. Focus remains of developing soft skills, communications, business communication skills and ability to perform in groups. The sessions on accounting are extremely useful for the students from non-commerce streams, while the sessions on quantitative techniques are found useful by commerce students. With these sessions, SBJM -CME tries to make a batch full of energetic, excited, informed students, ready to take load for coming academic rigor.

Nurturing by CEO and Successful Entrepreneurs

SBMJ-CME organizes 'Nurturing by CEO and Successful Entrepreneurs' where CEO's and Entrepreneurs of successful organizations share their leadership and decision making moments. SBJM-CME also helps students to grow logical thought processes through blending market data with management fundamentals.

Applied Management Techniques

Students are put into performance with multiple projects, assignments, surprise quiz, presentations, group activities and tests. These activities enable them to simultaneously survive and perform in this environment.

Profile and Professional Development

One needs to understand the perspective of each character to appreciate a good film. Likewise, students need to develop a holistic idea about the economic movement and changing power equations in the world.

Student's Centric

SBMJ-CME campus is a lifetime experience of learning, sharing and teaming-up. It's also a high pressure environment where students learn how to cope with corporate world and its expectations. Apart from education, they have fun and participate in various social activities, B-School events, and interventional competitions. These together make a holistic development of an individual.

Personality Enhancement Programmes (PEP) for Profile Development

PEP is an integral part of PPO. These life skills sessions are aimed at inculcating a professional approach towards the programme.

These include sessions on attitude, self motivation, time management, stress management, business etiquette, assertiveness, goal setting, personal effectiveness, presentation skills, team building, leadership approach.

Students Talk - This is what some of our students had to talk about placements at SBJMJC



“ The JGI Group provided us with the best of support and guidance - guest lectures by eminent academicians, international Toast Masters sessions, just to name a few. As a result, I have joined Citi Bank, one of the prominent players in the banking sector in the country. ”

Trinkul Kalita, Placed in Citi Bank



“ My experience with JGI in terms of creativity, innovativeness and entrepreneurship helped me to crack the interview and get placed with ORACLE. ”

Henry, Placed in Oracle



“ JGI fosters in you a sense of dedication and leadership, enabling you to face the global competition. With many other such values, which were instilled into me by the institution, I very proudly claim to be working in a reputed Aromatic company on a CTC of Rs 6 lakhs + variables. ”

Nikhil Subramaniam
Placed in Gem Aromatics Pvt. Ltd.



“ Gaining a lot of insight into the practical aspects of life through this programme, I was able to join naukri.com. I term the experience at college as 'life-changing'. Apart from being curriculum-oriented, the college offers a plethora of opportunities to showcase ones people and management skills. ”

Varun K, Placed in Naukri.com



“ With the immense learning scope that my college has provided, I have earned an outstanding opportunity to work with a reputed organization 'Ernst & Young'. ”

Sneha Saranghi
Intern - Ernst & Young.



“ Being from Riyadh, I was in for a pleasant surprise when I got an international placement with a reputed organization in Riyadh itself. I owe this to the highly qualified and exemplary faculty at JGI. ”

Danny Luke, Placed in Anexas



“ Market research being my chosen field, I joined Taj Westend on an internship. After successfully completing the internship, I have now joined an event management company, Encompass, since a month. I am thoroughly enjoying my job and the challenges that come with it. Thanks to The JGI Group for providing the platform. ”

Satpal Yadav
Intern - Taj Westend



“ Despite the disciplining and mentoring by experienced and learned faculty of the college, it wouldn't have been possible for me to work for Pantaloons Retail India Limited. I am and will be ever grateful to the college for instilling the right values of management in me. ”

Ansu Mary Abraham
Intern - Pantaloons Retail India limited.

Twinning is a flexible educational concept which widens the scope of educational opportunity and access for students, keeping in view of their weekly schedules of learning time. This concept gives a gamut of choices to the student community to learn and assimilate the nitty gritty of the subjects of various programmes through a well-designed and meticulously executed academic rigour, with standard courseware, learning kits and virtual ways.



Programme Architecture

TERM I	
•	Management Concepts & Practices*
•	Organizational Behaviour & HRM*
•	Marketing Management*
•	Accounting for Managers*
•	Business Economics & Environment*
•	Business Communication
•	Statutory Compliances for Business Organizations*
•	Quantitative Techniques for Business*
•	Business Finance*
•	Information & Communication Technology*
•	Organizational Leadership
•	Introduction to Entrepreneurship*
•	Entrepreneurial Lab
•	Production & Operations Management
•	Business Research Methods*

TERM III	
•	Personal & Managerial Effectiveness
•	Corporate Entrepreneurship-Theory and practice
•	Business Opportunity Guidance & Identification
•	Business Ethics & Corporate Governance
•	Business Negotiations
•	Business Plan
•	Corporate Social Responsibility
Research Project	
•	On the job Business Dynamics
•	Project Report and Viva-voce

TERM II	
•	Financial Markets & Instruments
•	International Business*
•	Strategic Business Management*
•	Operations Research
•	Management Information Systems*
•	Indian Economy
•	Export-Import Policy
•	Change & Knowledge Management
•	Logistics & Supply Chain Management
Marketing Specialization - I	
•	Sales & Retail Management*
•	Services Marketing*
•	Marketing Strategy
•	Consumer Behaviour & CRM*

“ I had thought it would be a routine college life of 4 hours session, but to my surprise the classes conducted here were completely different from my expectations. High level of interaction and one-to-one knowledge sharing concept helps us groom ourselves. ”

Ashish Sharma, PGDBM - 10

TERM IV	
•	Global Excellence Trail
Marketing Specialization - II	
•	Internet Marketing & e-Commerce*
•	International Marketing Management*
•	Marketing Communication & Brand Management*
•	Business Marketing*
Finance Specialization - I	
•	Investment Analysis & Portfolio Management
•	Business Taxation
•	Financial Services
OR	
HR Specialization - I	
•	Recruitment, Selection & Compensation Management
•	Training & Development
•	Human Capital Management - Power & Politics

TERM VI	
•	IIAM / IIAB Training

*Subjects covered under Pondicherry University - MBA

TERM V	
•	Global Business Environment
•	Total Quality Management
•	Entrepreneurial Marketing
Finance Specialization - II	
•	International Financial Management
•	Mergers & Acquisitions
•	Risk Management
OR	
HR Specialization - II	
•	Organizational Development
•	International HRM
•	Performance Management & Competency Mapping

Note: Subject order may change depending upon the availability of the Course Leader

“ This programme is shaping me into what I want. I am sure I will be able to transform and fine-tune myself into a highly skilled personality at the end of the tenure. ”

Prerana Gupta, I PGDBM - 10

Chenraj Jain Centre for Entrepreneurship Network serves as the hub to foster entrepreneurial thinking. It helps you to discover your individual passion, build knowledge, gain practical experience and foster networks and mentor relationships.

“ The vision of our chairman of creating 8800 entrepreneurs made me believe that I should be a job provider and not a job seeker. ”
 Jia Jain
 CEO, 1947, Chain of Restaurants



Fostering Entrepreneurial Thinking

NEN - a Wadhvani Foundation

The nonprofit National Entrepreneurship Network (NEN) was established in 2003 with a mission to create and support high-growth entrepreneurs, driving job-creation and economic growth in India. NEN represents India's largest and most dynamic community of new and future high-growth entrepreneurs, with over 70,000 members in 30 cities. It provides critical support to start-ups and early-stage entrepreneurs through high-impact entrepreneurship education; access to mentors and experts; fast-track access to incubation and funding; and learning tools and materials. Jain College has a tie up with NEN, - a Wadhvani Foundation to prepare our students for Entrepreneurship and Intrapreneurship.

Students in Free Enterprise - SIFE

SIFE (Students in Free Enterprise) is about social & economic empowerment of communities through student community by imparting entrepreneurial skills among a target audience and also the students and thereby impacting society at large.

The SIFE team of SBMJC has won many accolades including the Rookie award for the best debutant team and has also won the regionals & qualified for the semi-finals during National Competition 2010 at Mumbai. The team has also earned many grants such as KPMG Business Ethics Grant and KPMG Seed Money Grant.

“ I thought of joining my family business after my graduation. But there was some intuition in my mind that I should have done a professional course than simply going to business after graduation and that's where I decided to join this course. After the level of exposure I feel it's worth the decision. ”

Jagadish Patel, PGDBM - 09

SIFE Team at Mumbai when we won the regionals & qualified for the semi-finals during National Competition 2010.



SIFE member with the target community - Project Lakeweed.



Some of the innovative business projects initiated by our students

- Basket Option Pvt. Ltd
- Aqua Vita R O Systems Pvt. Ltd.
- Claimsexpress
- ARKA Eduserve Pvt. Ltd.
- Samaavesh
- ARKA Infrastructure Pvt. Ltd
- 1947
- House of Music
- Made in India
- MACTADS
- Healthy Bites
- JCH Hospitality
- Insignia Hospitality Pvt. Ltd.
- A2A Catalyst
- Intouch Analytics Pvt. Ltd.
- Chrysalis India (P) Ltd.
- Globals Inc
- Blueman Support Services Pvt. Ltd.
- Vindya E Infomedia
- Navami Solutions
- Damask
- Chequered Flag Entertainment
- Insight Consultancy Services Pvt. Ltd.
- Chromozome
- Drone Aerospace
- Bazaar Clicks
- LED Tech
- Stock Via
- Merustones
- Fore Square Decor
- Vridhi
- International Franchise Arena
- Inoyise
- Namaste India
- Brain Work
- Splash Associates
- MANAS
- Gaia Green Solutions
- Geekey Dhaba
- Sonido
- Café Gossip
- Demat Rox
- R H Commodities
- Between the Buns
- Concept Incorporation
- Geo Model Service
- Sarkaar
- Just Parathas

“ The Entrepreneurship Training and Development at the college helped me to venture into veneers and building materials trading. My sincere gratitude to the institution for making me what I'm today. ”



Jagdish Patel
Entrepreneur



Finding Your Passion

Whether you are driven by a burning business idea, a pressing social need or a desire to lead innovation discovering your unique passion is a critical first step on the pathway to successful entrepreneurship. The Chenraj Jain Centre for Entrepreneurship Network provides you the opportunity to explore many kinds of venture and types of entrepreneurship and decide which is right for you.

Building Knowledge

Chenraj Jain Centre for Entrepreneurship Network encompasses a sequence set of four courses that combine theoretical and experiential learning including the hands-on practicum where students work with an entrepreneurial CEO on a high level consultant project.

Entrepreneurship Feasibility Assessment

In this team based course, you will assess yourself and your interests, learn how to gauge opportunities in terms of market potential and examine the strategic, operational, financial, and market viability of a business idea.

Business Plans and Proposals

A well-honed business plan is not just your venture road map; it is a critical asset for attracting seed capital, partners and advisors. In the second course you will develop a professional business plan for your own venture idea using financial forecasting and in depth market research; discover the multiple ways of legally establishing a for-profit business or social venture; chart growth option and their implications; and learn the cost and benefits of various financing vehicles.



Entrepreneurship Lab

The practicum is an immersive, hands-on experience in which you will partner one-to-one with a successful entrepreneur to complete a professional consulting assignment. The lab is “Entrepreneurship-in-Action” allowing you to complete a project of strategic importance while you gather experience and contacts to support your own objectives. With special approval from the faculty, you can use this course to launch your own venture.

Managing High Growth Firm

Launching a business is exciting, but growing (and staying in) business is the true mark of a successful entrepreneur. You will uncover the precise resources required during each stage of a new venture; funding start-up building market awareness and growing relationships with customers, employees and suppliers. You also will learn about “company killers” and how to safe guard against common pitfalls.

Fostering Networks and Mentoring Relationships

At Chenraj Jain Centre for Entrepreneurship Network, we understand that developing entrepreneurial readiness is facilitated by exposure to role models and coaches who have triumphed. Throughout this innovative programme, we will provide you with valuable opportunities to make connections, build networks, and develop mentoring relationship. In the classroom, you will be surrounded by other talented students who share your goals of building a successful business and who will become a life long resource. You will also have continuous access to the broader CJEN Entrepreneurship community of faculty (including successful entrepreneurs), researchers, advisors, and business leaders.

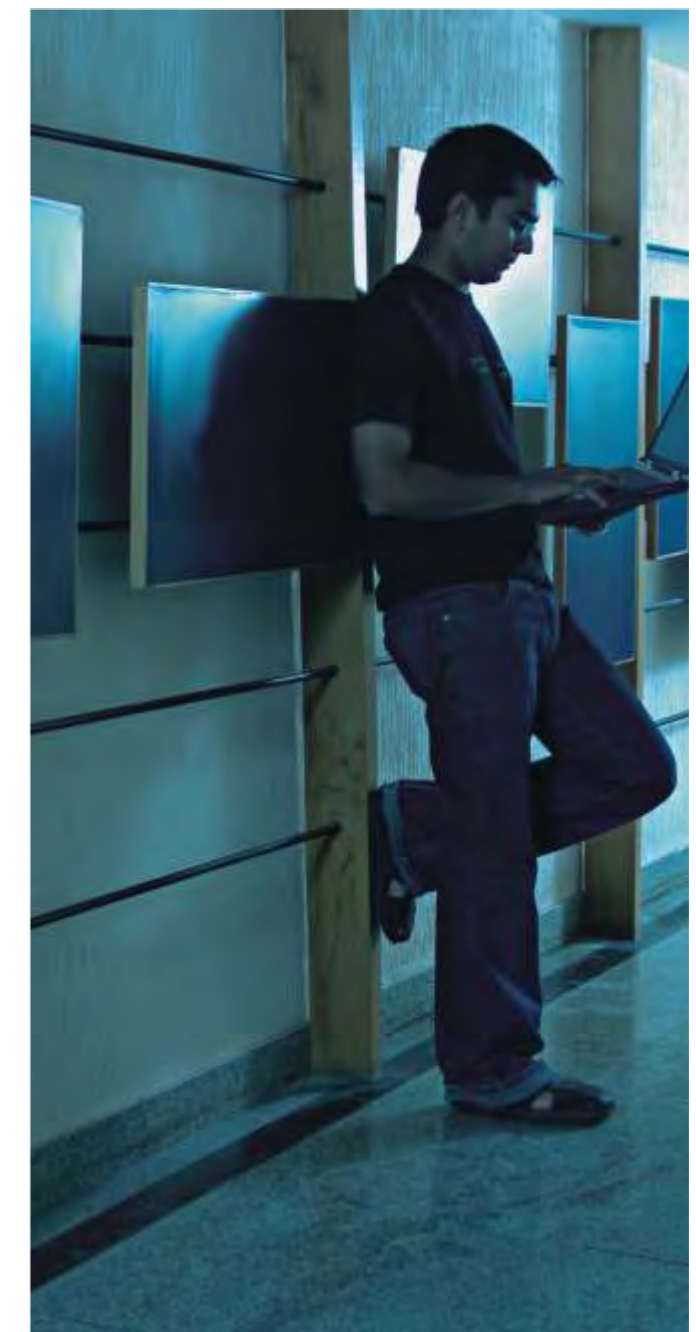

SBMJC has a full fledged placement cell which caters to the needs of the corporate world. A group consisting of Corporate Relations Executives & Coordinators bridge the gap between theory & practice. Our students find success in different fields like Finance, Consulting, Marketing, Healthcare, Retail and other sectors.

“ This programme gave me a break in a pharma MNC as a Manager & not as a Representative. ”

Srinivas Reddy
PGDBM - 09



Developing your Employability

Recruiters consistently turn to SBJMC because its students & alumni are valued not only for their business acumen but also for their ability to collaborate and lead. Over 400 top companies in major industries have an active recruitment relationship with SBJMC. Our customized curriculum and highly qualified faculty prepare you to succeed in your chosen career. Our alumni network is another important resource that will enhance career opportunities.

The placement cell organizes the short term internship, the final semester on the job training and also the post training placements for eligible students. Moreover most of the industry leaders from the corporate world give a prelude to placements. Students who enroll for placements undergo a Campus to Corporate Finishing School Programme to enable them for successful placements.

Companies supporting our campus recruitment drive

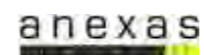

Stemming directly from the vision of overall student development, we provide facilities and encouragement for every sport activity that students find interest in.

“Playing different sports in the campus and spending time together helped us familiarize & bond amongst peers.”

Rahul Singhania
PGDBM - 09



Golf course at Jain Globus Campus

Active Life

Exceptional talents are given adequate encouragement to emerge as winning performers in their chosen sporting disciplines. This is illustrated by the number of students across SBMJC who have represented the country at many levels and by the many individuals who have achieved international standing in their chosen sport. Some of our star performers include: Pankaj Advani, Shika Tandon, Robin Uttappa, Rehan Pooncha, Anup Sridhar, Gaurav Dhiman and many more.

Billiards & Snokker, Tennis court and Bowling Alley at the Jain Global Campus



“I have so much support from my college, so much so that we would have special classes at the end of the year. I completely enjoy studying here. It took a lot of pressure off me while playing my cricket. I owe a lot of my success to this college.”

Robin Uthappa, Jain College Alumni & International Cricketer

Quality Sporting Facilities

The global campus provides world-class infrastructure for sports in its sprawling campus of 300 acres. A choice of more than 30 playing areas for almost all major indoor and outdoor games gives the college sports a dominant appearance.

- An indoor stadium with a total built up area of 80,000 sq feet facilitates almost all indoor games
- An ultra modern aquatic centre comprising 25 mtr 08 lane short course swimming pool, a 50 mtr 10 lane competition pool with water polo facilities and a separate diving pool
- A well designed 2 lakh sq ft lush green international standards cricket ground fit enough to match any international or national cricket ground
- Six plexi-cushion tennis courts
- Five volleyball courts and four basketball courts
- An international class 6 hole golf driving range is designed, where students pride their time in this truly serene landscaped setting
- Two lush green international standards turf football ground
- A natural turf hockey ground of international standards
- A 400 mtr natural track, athletic arena and a covered stand, with a seating capacity of more than 5000
- A full-fledged gymnasium with the latest equipments for physical conditioning



The Jain College Hostels, located across South Bangalore are the preferred residential option for students. The hostels offer separate spacious accommodation for boys & girls with food, laundry and recreational facilities.

“ JCH is truly a home away from home for me. ”

Khushboo Purohit
PGDBM - 10



JCH Cafeteria

Settling In

JCH is not just a place of stay but promotes social understanding among students of various disciplines, background & culture. JCH has a total of 9 hostels with over 180 staff members, constantly working towards making the student's stay comfortable. It shelters over 900 students and serves around 3600 plates of food everyday.

Exceptional Services

- Comfortable boarding
- Quality vegetarian food
- Hygienic environment
- 24/7 security arrangement
- Extended career counseling
- Online magazines and newsletters
- Bi-yearly reports to parents ensuring the general well-being of their ward
- Housekeeping services
- 24/7 wireless internet facility
- Pick up & drop facility from railway station & bus terminal
- Effectively monitored time-in & time-out
- Tie-up with hospital enures 24/7 medical facilities
- Medi-Claim insurance for every student
- Events & social gathering like trekking & excursions on weekends & holidays
- Recreational activities like cricket, football, table tennis tournaments are organized

Daily Food Menu*

- **Breakfast** - Cornflakes & milk or fresh fruits in addition to breakfast
- **Lunch** - Roti / chapati / poori served along with 2 vegetables & 1 variety of dal / sambar, white rice, curd / butter milk.
- **Evening Snacks** - Tea / coffee / juice with light snacks
- **Dinner** - Roti / chapati / poori / parathas served along with 2 vegetables & 1 variety of dal / sambar, white rice, 1 mixed rice & desert

* Standard menu.
Subject to availability



A Partial View of JCH

“ This is one institution which fulfills what it commits. ”

Sujata Phukan
PGDBM - 10



Students on a Weekend Tour

Bangalore is India's third most populous city and fifth most populous urban agglomeration. Today, as a large and growing metropolis, Bangalore is home to some of the most recognized colleges and research institutions in India.



Enchanting City of Bangalore

A demographically diverse city, Bangalore is a major economic hub and the fastest growing major metropolis in India. Numerous public sectors, heavy industries, software companies, aerospace, telecommunications, and defense organisations are located in the city. Bangalore is known as the Silicon Valley of India because of its pre-eminent position as the nation's leading IT employer and exporter.

The city with an electric spirit, Bangalore has always attracted talents from all over India and across the world. It is a city with cosmopolitan culture. Just when one steps into the city he can feel its pulse. It is a city vibrant with its jazz festivals, fashion trends and the old age craft. The city accommodates one and all, so that everyone can happily co-exist.

Not just the places, the food of Bangalore also forms a key area of interest for many. South Indian food is one of the healthiest as it is mostly non-greasy, roasted and steamed. If you feel homesick and are on the look out for some home food, this city would not disappoint you. It makes you feel at home, providing you with all the facilities that you might require during your stay.



Facilitating Academic Excellence



Partial List :

Dr. Easwaran Iyer - Dean
M.Com, LLB, PGDBM, PGDPM, M.Phil, PhD
EEC (IIMB and Stanford)
Industry & Academic Experience - 33 Years

Dr. Dhimant Ganatra - Associate Dean
B.E., MBA, PhD
Industry & Academic Experience - 14 Years

Dr. Vishal Arora
BBM, MBA, PhD, EEC (IIMB and Stanford)
Industry & Academic Experience - 8 Years

Prof. Ajit Chakravarti
B.Tech (IITK), PGDM (IIMC)
Industry & Academic Experience - 36 Years

Prof. Alok Chhajer
B.Sc., PGDM, CFP
Industry & Academic Experience - 7 Years

Prof. Amitabh Saxena
B.E., MBA, Six Sigma - Master Belt
Industry & Academic Experience - 21 Years

Prof. Anupama Ghoshal
BA, PGDCA, MBA, M. Phil
Industry & Academic Experience - 12 Years

Prof. A.S. Velpanur
B.Sc., CAIIB – I, EMBA, Dip in Finance (CFM)
Industry & Academic Experience - 34 Years

Prof. Balaji Rao
B.Com, PGDMM
Industry & Academic Experience - 23 Years

Prof. B K Kumar
PGDM (IIM Ahmedabad)
Industry & Academic Experience - 36 Years

Prof. Gurunandan B
BBM, ICWA
Industry & Academic Experience - 6 Years

Prof. H.A.C Poppen
MA (PM&IR) (TISS), LLB
Industry & Academic Experience - 40 Years

Prof. Hemanth Kumar S
B.E., MBA
Industry & Academic Experience - 13 Years

Prof. Jessy Nair
B.Sc., MBA, M.Phil, (PhD)
Industry & Academic Experience - 9 Years

Prof. Kiran Bindu
M.Com, ICWAI
Industry & Academic Experience - 21 Years

Prof. K N Guha
B.Sc, LLB, CAIIB
Industry & Academic Experience - 40 Years

Prof. L. Surendra
B.E., M. Tech. (IIT Madras), PGDM (IIMA)
Industry & Academic Experience - 35 Years

Dr. M. Ambashankar
B.E., M.Tech (BITS Pillani), MBA, PhD
Industry & Academic Experience - 32 Years

Prof. M.M. Gupta
MA (Economics)
Industry & Academic Experience - 40 Years

Prof. Mohan Kuruvilla
B.Sc (Hons), MA, PGDBA (XLRI)
Industry & Academic Experience - 19 Years

Prof. M. Rajiv
B.E., MBA
Industry & Academic Experience - 26 Years

Prof. Naganand V
MBA (Advt)
Industry & Academic Experience - 21 Years

Prof. N Chandrasekhar
B.E., BL, MHRM, M. Phil
Industry & Academic Experience - 30 Years

Prof. Nisha Shankar
BBM, MBA, (PhD)
Industry & Academic Experience - 11 Years

Prof. Nishanth B
B.E., MBA
Industry & Academic Experience - 3 Years

Prof. Padmalini
MBA
Industry & Academic Experience - 2 Years

Prof. Payal Roy
PGDBM
Industry & Academic Experience - 3 Years

Prof. P.N. Nanaiah
M.Sc., RA (Hiroshima University, Japan), M.T (DCM Delhi), Exec. Program (IIM Kolkatta), (NIS, Delhi)
Industry & Academic Experience - 28 Years

Prof. Poonam Namjoshi
M.Com, M.Phil, (CA)
Industry & Academic Experience - 10 Years

Prof. Pragati Shukla
LLB (UK)
Industry & Academic Experience - 17 Years

Prof. P. S Gopinath
B.Sc. (Engg.), PGPM (IIM Ahmedabad)
Industry & Academic Experience - 30 Years

Prof. P Sudarshan
B.Tech (IIT-Madras), PGDM (IIM Ahmedabad)
Industry & Academic Experience - 40 Years

Prof. Punith Cariappa
M.Com, MBA, M.Phil, (PhD)
Industry & Academic Experience - 18 Years

Prof. Ramesh S
M.Com, MBA, LLB, ACS
Industry & Academic Experience - 25 Years

Prof. Rajendran Thangadurai
B.E., M.Tech (IIT Kanpur), CPIM
Industry & Academic Experience - 20 Years

Prof. Rajiv K Sharma
BBM, MBA
Industry & Academic Experience - 6 Years

Prof. Renu Kotian
PGDBM
Industry & Academic Experience - 3 Years

Prof. Rishiraj Dasgupta
B.E., PGDM (IIMC)
Industry & Academic Experience - 10 Years

Prof. R. R. Simha
B.Sc., B.Com, CAIIB
Industry & Academic Experience - 40 Years

Prof. R Sathyanarayana
MA, PGMM, MDP (XLRI)
Industry & Academic Experience - 35 Years

Prof. R. Srinivasan
B.E., PGDIT (IIFT, New Delhi)
Industry & Academic Experience - 24 Years

Prof. Sadashiv K
MBA, ICWA
Industry & Academic Experience - 4 Years

Prof. Sameerkanth
MBA, EEC (IIMB and Stanford)
Industry & Academic Experience - 18 Years

Prof. Saroja Ramnarayan
B.Com, DCP
Industry & Academic Experience - 30 Years

Prof. Satish Kumar S
B.E., PGDBM (XLRI)
Industry & Academic Experience - 22 Years

Prof. Sidhanta Patnaik
BBM, MBA
Industry & Academic Experience - 5 Years

Prof. S.N. Murthy
B.E., MBA (IIM Kolkata)
Industry & Academic Experience - 36 Years

Dr. S Sharmila
M.Com, LLB, MBA, M.Phil, PhD
Industry & Academic Experience - 21 Years

Prof. Surojit Saha
MS, MBA, E-MBA (IIMC)
Industry & Academic Experience - 3 Years

Prof. Swapan K Nandy
B.E., M. Tech. (IIT Khargpur)
Industry & Academic Experience - 30 Years

Dr. V Rajesh Kumar
M.Com, Ph.D
Industry & Academic Experience - 17 Years

Prof. Veena Venugopal
BBM, MBA, M. Phil, (PhD)
Industry & Academic Experience - 9 Years

Prof. Vinay V Giri
B.Com., LLB
Industry & Academic Experience - 11 Years

Ms. Sowmya G.S (Student Support Team)
BBM, MBA
Industry & Academic Experience - 4 Years

Mr. Navin Jaiswal (Student Support Team)
B.Com, PGDBM
Industry & Academic Experience - 2 Years

Mr. Anubhav Pratap Singh (Student Support Team)
BBM, PGDM
Industry & Academic Experience - 2 Years

The Times of India Samyuktha Karnataka



Deco... aaka Ind... of India The Hindu

The Times of India Banga



Deccan Herald Bangalore



Prajavani The Hindu



The team from Bhagwan Mahaveer Jain College that won the overall championship of the sports meet held at Garden City College recently

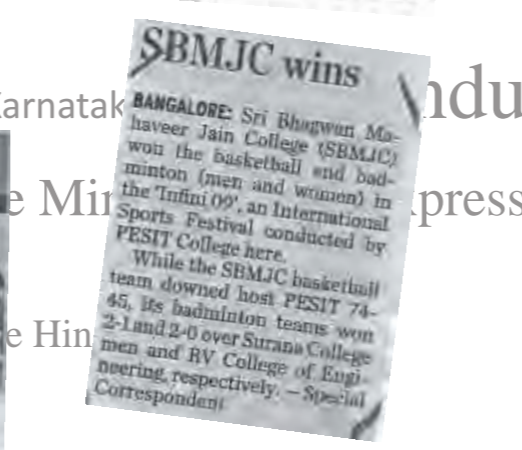

The students of Bhagwan Mahaveer Jain college get Net Junky



'ಗುಣಮಟ್ಟದ ಎಲೆಕ್ಟ್ರಿಕ್ ಉಪಕರಣ ಬಳಸಿ'



The right stress-buster The Hindu



atataka Indian Express

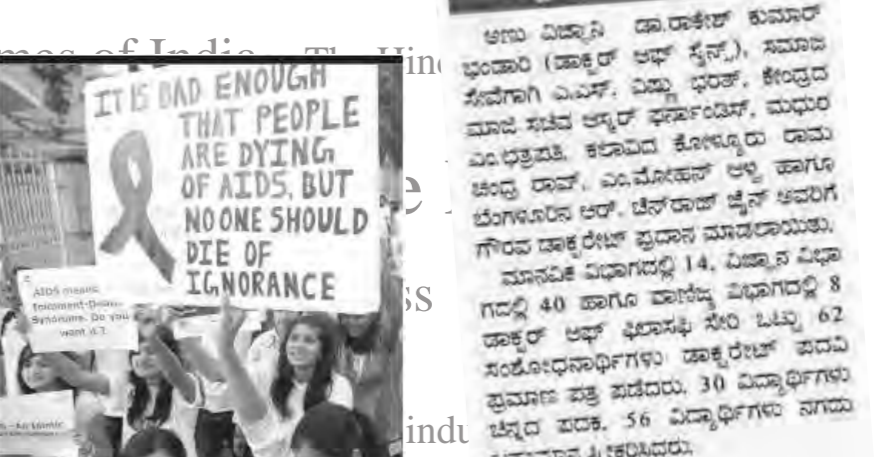

Students of Mahaveer Jain College take out a procession from J C road to Lalbagh as part of the Social Awareness Week in Bangalore on Tuesday



Corporate Speak

Ms. C K Vanitha

Bajaj Capital

It's really interesting to meet an institution which does things differently like us. We see a good difference in the quality of candidates when compared to the other college candidates. We hope that their activities will strengthen the growth of India.

Mr. Venkatesh

Accenture

Excellent college with good infrastructure and the knowledge of students on the subject is commendable.

Ms. Ramya R

Ernst & Young

Great experience! A very bright group of future leaders. Smart and ready for the corporate life! I'm looking forward to more interaction with The JGI Group.

Mr. Nagarajan S

24/7 Customer

Very vibrant bunch of students and a very good initiative has been taken by the college to include industry experts to give speech to students.

Mr. Srikanth

Cognizant

Excellent facilities and good set of people are seen managing the placement office. Energy levels of students is also great.

Mr. Naveen

TCS

Excellent hospitality, good infrastructure, warm support and help rendered at every juncture of placements.

Ms. Gunjan

Infosys BPO Ltd.,

Wonderful experience very satisfied with your institute's talent pool! We will keep coming back!

Mr. Brian Greeff

Goldman Sachs

Always welcoming and a hospitable reception. We are looking forward to our next visit!

Shahela sajanlal

Google India

Excellent infrastructure, amazingly smart students & very organised placement cell. We look forward to recruiting your students!

Mr. Almon Prem

IBM Daksh /BPO

Surprises me that the students are already very well linked with the corporate world. I admire the hospitality extended by the Management.

Ms. Divya Acharya

TCS

It was indeed a pleasure visiting SBMJC. The students are good with the subjects that they have learnt & it was a pleasure interviewing them. We look forward to visiting SBMJC again.

Ms. Shewetambari D N Prasad

Google India

Refreshing experience, they are better than the BEST!





Academic Collaborations



Corporate Collaborations



THE JGI GROUP

Committed to Excellence and Human Development

www.jgi.ac.in

Fast Facts

Founder Chairman

Dr. R Chenraj Jain

Founded

1990

Campus

25 locations

Areas

Education and Research

Entrepreneurship

Sustainable Development & Social Responsibility

Education

Free Schools

P - 12 Schools

Colleges

University

Management & Professional Institutions

Students

30000

Employees

3120



P - 12 Schools

Jain International Residential School, Kanakapura, Karnataka

Jain Heritage School, Bangalore, Karnataka

Jain Heritage School, Nagpur, Maharashtra

Jain Heritage School, Tirupathi, Andhra Pradesh

Jain Heritage a Cambridge School, Hyderabad, Andhra Pradesh

Jain Heritage a Cambridge School, Visakhapatnam, Andhra Pradesh

Jain Public School, Kanakapura, Karnataka

Jain Public School, Davanagere, Karnataka

Jain Public School, Ratlam, Madhya Pradesh

Jain Public School, Badnagar, Madhya Pradesh

Jain Public School, Jhabua, Madhya Pradesh

Jain Public School, Kadri, Andhra Pradesh

Jain Public School, Secunderabad, Andhra Pradesh

Jain Public School, Ranebennur, Karnataka

Jain Public School, Korba, Chhattisgarh

Jain Public School, Tumkur, Karnataka

The Jain International School, Bangarpet, Karnataka

The Jain International School, Krishnapuram, KGF, Karnataka

The Jain International School, Bilaspur, Chhattisgarh

The Jain International School, Kanpur, Uttar Pradesh

The Jain International School, Hubli, Karnataka

Jain Toddlers, Jubilee Hills, Hyderabad, Andhra Pradesh

Jain Toddlers, Mahindra Hills, Secunderabad, Andhra Pradesh

Jain Toddlers, Kanpur, Uttar Pradesh

Jain Toddlers, Hubli, Karnataka

Jain Toddlers, Aurangabad, Maharashtra

Sports Schools

Jain Academy for Sporting Excellence, Kanakapura, Karnataka

Jain Academy for Sporting Excellence, Hyderabad, Andhra Pradesh

Colleges (Pre-University, Under Graduate & Post Graduate)

Sri Bhagawan Mahaveer Jain College, V V Puram, Bangalore, Karnataka

Sri Bhagawan Mahaveer Jain College, J C Road, Bangalore, Karnataka

Jain College, Jayanagar, Bangalore, Karnataka

Jain College, R R Nagar, Bangalore, Karnataka

Sri Bhagawan Mahaveer Jain College, K.G.F, Karnataka

Sri Bhagawan Mahaveer Jain Evening College, V V Puram, Bangalore, Karnataka

Sri Bhagawan Mahaveer Jain Evening College, J C Road, Bangalore, Karnataka

Jain College, Belgaum, Karnataka

Jain College, Kanakapura, Karnataka

Jain College, Hubli, Karnataka

Jain College of Engineering, Belgaum, Karnataka

Centre for Design, Bangalore, Karnataka

Jain University (Constituent Schools and Centres)

School of Graduate Studies, J C Road, Bangalore, Karnataka

School of Graduate Studies, V V Puram, Bangalore, Karnataka

Center for Management Studies, Bangalore, Karnataka

School of Engineering and Technology, Kanakapura, Karnataka

Centre for Post Graduate Studies, Bangalore, Karnataka



Centre for Research in Social Sciences and Education, Bangalore, Karnataka

Centre for Research in Emerging Technologies, Kanakapura, Karnataka

Centre for Disaster Mitigation, Bangalore, Karnataka

International Institute for Aerospace Engineering and



Management, Bangalore, Karnataka

Centre for Research in Pure and Applied Sciences, Bangalore, Karnataka

RCJ Centre for Entrepreneurship, Bangalore, Karnataka

Management & Professional Excellence Institutions

MATS Institute of Management & Entrepreneurship, Bangalore, Karnataka

International Academy for Creative Teaching, Bangalore, Karnataka

Human Networking Academy, Bangalore, Karnataka

Genohelix Biolabs, Bangalore, Karnataka

School for Leadership and Excellence, Bangalore, Karnataka

Jain Animation School, Bangalore, Karnataka

JGI Life (JGI's Social Initiatives)

Jain Vidyaniketan (An Opportunity School), Kanakapura, Karnataka

Jain Vidyaniketan (An Opportunity School), Amethi, Uttar Pradesh

Radio Active CR 90.4 MHz, Bangalore, Karnataka

Campus Location

By Road

Sri Bhagawan Mahaveer Jain College is around 10 kms from Kempegowda Bus Station. It is well operated by private transports from all parts of Bangalore.

By Train

Sri Bhagawan Mahaveer Jain College is around 10 kms from Bangalore City Railway Station.

By Air

Sri Bhagawan Mahaveer Jain College is around 45 kms from Bangalore International Airport. A/C shuttle services, taxi and auto rickshaws are available for easy transport.



Admission Criteria

Eligibility

- Candidates with a valid score in MAT / CAT / XAT / ATMA and an aggregate of 50% in undergraduate programme, without any back logs are eligible to apply

Selection Process

- 50% is specified as the minimum score in graduation examination but preference shall be given to students with 60% and above in their 10th, 12th and graduation exams
- Candidates with full time work experience of one year and above will be given preference
- Topics will be given to candidates in advance for the Presentation skills Assessment (PSA). They will be assessed based on content, presentation skills, fluency, clarity and Q & A
- Candidates who qualify based on the above criteria will be short listed for the personal interview round

Basket Option Education Consultancy

With the view for uninterrupted and hassle free education for every student, The JGI Group has appointed Basket Option Pvt. Ltd, to provide facility of Student Insurance and Education Loan*.

Basket Option Pvt. Ltd. is an ISO 9001-2000 certified company, managing Corporate, Institutions and Individuals, Investment, Insurance & Loan portfolios. Basket Option education consultancy is India's first education consultancy which provides whole gamut of services like student Academic Counselling, Over Seas Studies, Education Loans from renowned leading financial institutions in the market.

In their endeavour to serve the student community and help the students to opt for their desired course and get the education loan support they are happy to provide educational loan from Credila, a HDFC Ltd. venture. With this Student can bank on Basket Option Pvt. Ltd. for hassle free and quick loan process.

For details on loan contact: 9743077744 or SMS to BASKET (space) LOANS to 56767

*T & C apply

